

IEMSA VOICE

A VOICE FOR POSITIVE CHANGE IN IOWA EMS

IEMSA CONFERENCE & TRADE SHOW

IOWA EVENTS CENTER • DES MOINES, IA • NOVEMBER 7-9, 2019

REGISTER TODAY!

REGISTRATION FORM AND SCHEDULE INSIDE

INSIDE THIS ISSUE

 Department of
HUMAN SERVICES | Abuse and Neglect Services | Child Welfare Services | Family Services | Health Care | Mental Health and Disability Services | Substance Abuse Services | Temporary Assistance for Needy Families (TANF) | Medicaid | Public Notice: Implement A Ground Emergency Medical Transportation (GEMT) Supplemental Payment Program

GEMT: MEDICAID SUPPLEMENTAL PAYMENT PROGRAM

31 IEMSA HAS BEEN WORKING WITH
THE IOWA DHS SINCE 2018 ON THIS
IMPORTANT PROGRAM--WE'RE CLOSE
TO MAKING IT HAPPEN!



LifeFlight

Serving Central Iowa for 40 Years

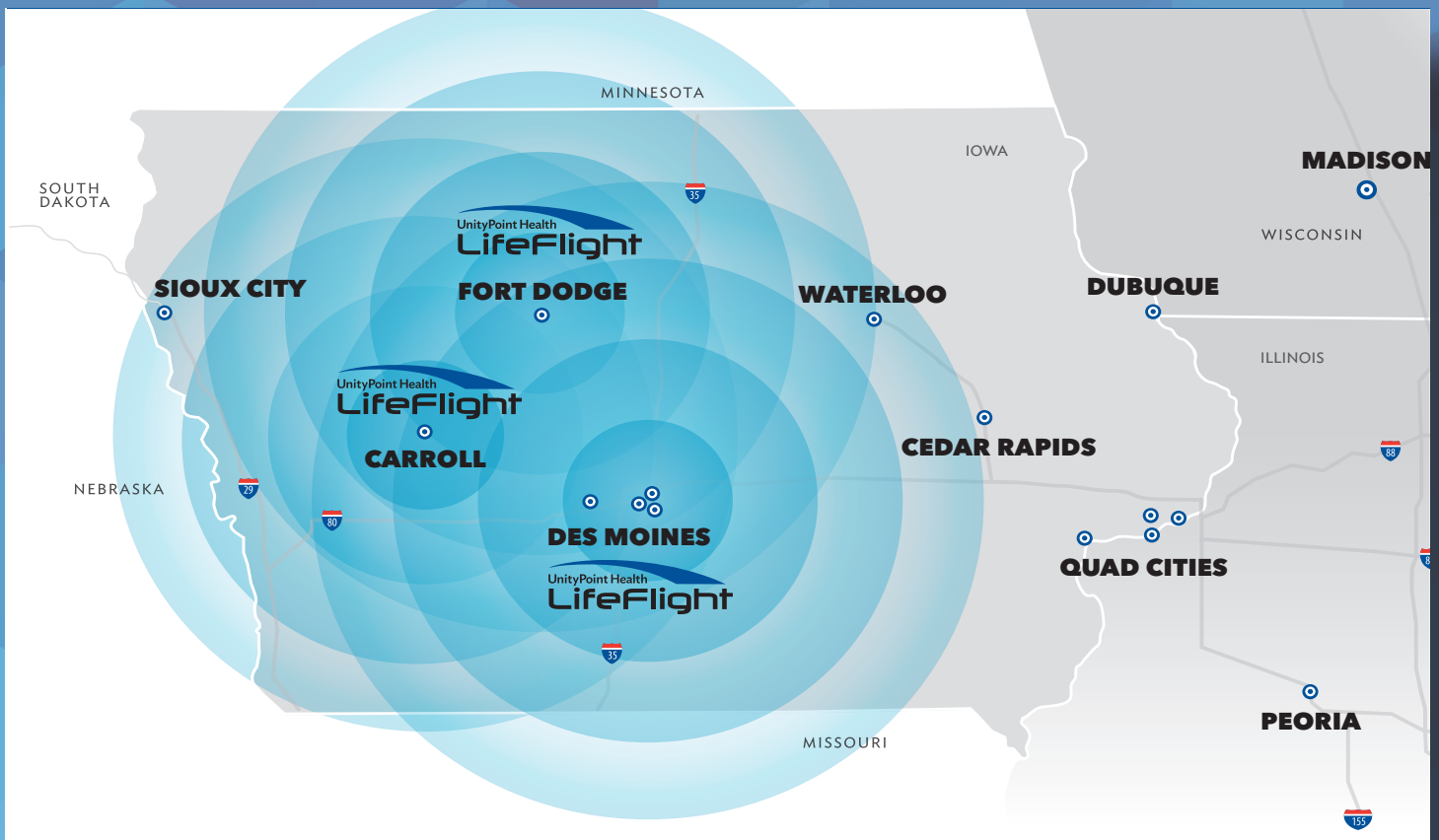

Come visit
us at our
IEMSA booth.

UnityPoint Health
LifeFlight

> CONTENTS

The VOICE is published quarterly by the Iowa EMS Association covering state EMS issues for emergency medical services professionals serving in every capacity across Iowa. Also available to members online.

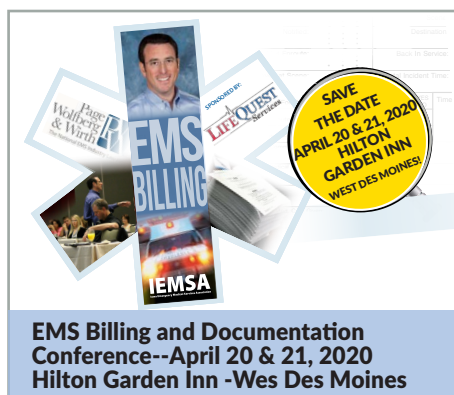

**16TH ANNUAL REGIONAL BILLING
15 CONFERENCE :** CE'S FOR EMS
BILLING MANAGERS & CERTIFIED
AMBULANCE CODERS

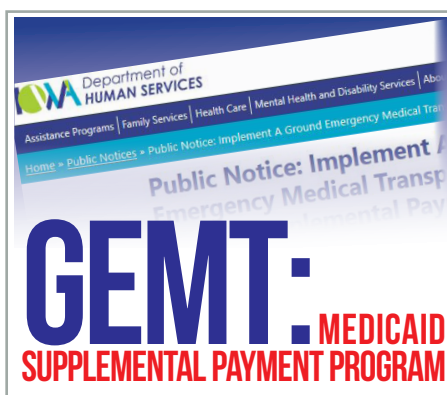

**IEMSA HAS BEEN WORKING WITH
31 THE IOWA DHS SINCE 2018 ON THIS
IMPORTANT PROGRAM--WE'RE CLOSE
TO MAKING IT HAPPEN!**

OUR PURPOSE : To provide a voice and promote the highest quality and standards of Iowa's Emergency Medical Services.

> BOARD OF DIRECTORS

- > President : Mark Sachen
 - > Vice President : Jerry Ewers
 - > Secretary : Tom Summitt
 - > Treasurer : Brandon Smith
 - > Immediate Past President : Mark McCulloch
-
- > Northwest Region : John Jorgensen, LaDonna Crilly, Tracy Foltz
 - > Southwest Region : Sarah Solt, Nella Seivert, Jason Wickizer
 - > North Central Region : Gary Merrill, Mark Sachen
 - > South Central Region : Mark McCulloch, Katy Thornton, Jana Trede
 - > Northeast Region : Amy Gehrke, Rick Morgan, Andy Ney
 - > Southeast Region : Thomas Summitt, Matthew Fults, Linda Frederiksen
 - > At-Large : Jerry Ewers, Brandon Smith, Dawn Brus
 - > Education : David Filipp, Brian Rechkemmer
 - > Medical Director : Christopher Hill, D.O.
 - > Lobbyists : Eric Goranson, Karla Fultz McHenry

> BOARD MEETINGS

- > September 19, 2019
WDM Station 19- 1:00—3:00pm
- > October 17, 2019
WDM Station 19- 1:00—3:00pm
- > December 19, 2019
Teleconference - 1:00—3:00pm

> IEMSA OFFICE

5550 Wild Rose Ln. , Suite 400
West Des Moines, IA 50266

515.225.8079 • fax: (877) 478-0926
email: administration@iemsanet
Office Manager: Lisa Cota Arndt

05	PRESIDENT'S NOTE : EMS CRISIS
06	LEGISLATIVE UPDATE : A SOLID AND ACTIVE 2019 LEGISLATIVE SESSION
08	EMS MEMORIAL CEREMONY: SIX EMS HEROES HONORED
15	WHY JOIN IEMSA— ASSOCIATION
11	AFFILIATE MEMBERSHIP : WHY SHOULD MY SERVICE JOIN IEMSA?
17	BILLING CONFERENCE UPDATE: 2020 DATE IS SET FOR APRIL 20 & 21 AT THE HILTON GARDEN INN & EVENT CENTER IN WEST DES MOINES
19	BUREAU OF EMERGENCY & TRAUMA SERVICES UPDATE : SAVING RURAL EMS
21	2019 ANNUAL IEMSA CONFERENCE BROCHURE & REGISTRATION FORM
30	CE TRAINING : CARBON MONOXIDE POISONING--earn 1 optional CE
31	GEMT (GROUND EMERGENCY TRANSPORTATION) PROGRAM: MEDICAID SUPPLEMENTAL PAYMENT PROGRAM
34	IEMSA BOARD NOMINATIONS : NOMINATIONS DUE 10/15
35	IEMSA TRAINING SPOTLIGHT : CENTRAL IOWA COMMUNITY COLLEGE

Emergency air transport.
All day. Every day.



MercyOne Air Med

1-800-247-1911

Des Moines | Knoxville

Mason City | Sioux City



A NOTE FROM OUR PRESIDENT

EMS CRISIS

BY MARK SACHEN, IEMSA President & EMS Provider, Nora Springs Volunteer Ambulance

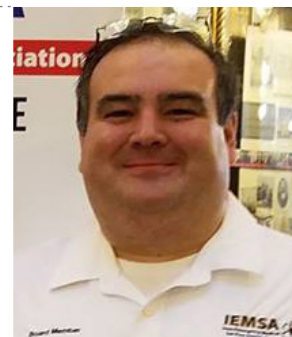

> The EMS crisis that is happening across the nation is real and is affecting us here in Iowa. Finding sources of sustainable funding, battling low reimbursement rates, attracting and retaining providers to replace an aging workforce that is retiring out of EMS, and the struggle to make EMS an essential service are all major issues we need to address to ensure the survival of emergency medical services in our state.

> The Iowa EMS Association recognizes the importance of our smaller rural services in our state and the critical need for them to succeed. Last December, the IEMSA Board of Directors elected me, an EMT for one of the smallest volunteer services in our state to lead this organization at this critical juncture. With an amazing board of talented and knowledgeable regional representatives, IEMSA is more than ready to take on these challenges.

> Unfortunately, negative past experiences with organizations and entities as well as interpersonal issues are holding us collectively back from working together to make the necessary changes to ensure Iowans have access to the best pre-hospital emergency care. Until all parties are willing to let go of past organizational, departmental and personal issues and commit to moving forward to better

EMS, we as an industry and profession (be it paid OR volunteer) will continue down this unsustainable path.

> Keeping a broken system in place is a notion that will be no more effective than it was initially.

> Continuing to operate a failing system “the way we always have”, is not going to fix what’s broken. A cooperative effort among our state’s services, providers, collective associations and the Bureau can be a solution to make some sometimes unpopular changes to ensure EMS survives and thrives.

> In closing, I would like to say that IEMSA’s Board of Directors are a dedicated and diverse group of hard-working EMS providers representing Iowa’s EMS professionals (paid and volunteer) and our EMS services. The mix of paid, volunteer, rural and urban representatives serve our members (and non-members) with best representation possible. I, along with the entire board, am dedicated to serving Iowa’s EMS services and providers and unfortunately sometimes, that means taking a position that not all people will agree with. We’re certainly responsive to those we represent and are always willing to listen to all viewpoints. Obviously, the long-term viability and success of our state’s EMS system is our common concern and we’d like to work with you to ensure that goal.



BY ERIC GORANSON IEMSA Lobbyist

OUR VOICE ON THE HILL LEGISLATION



**2019 LEGISLATIVE SESSION POST MORTEM
AND ACTIVE 2019 LEGISLATIVE SESSION, WITH
KEY VICTORIES AND CONTINUED SUPPORT
VOICED FROM OUR FRIENDS IN CAPITOL..**

> **GEMT - IEMSA led a coalition of groups that worked extensively on ground emergency medical transport (GEMT) funding.** As of 8/30/2019-- GEMT State Plan Amendment has been approved, and the GEMT cost report form and cost report instructions are available on the Medicaid website at the following link:

<https://dhs.iowa.gov/ime/providers/tools-trainings-and-services/medicaid-initiatives/GEMT>

The IGT agreement is still being reviewed internally so it is not available yet. After approval, the document will be available to download on the same website page as the cost report form.

> **The legislature passed an overall budget of approximately \$7.64 billion.** The biggest increase was \$150 million more for Medicaid Managed Care Companies, increases in K-12 education resulting in a total of \$3.3 billion, and increases to tax credits and incentives for rural housing, future ready Iowa, and other economic growth programs. The budget is a 0.2% increase over the budget passed last year. This new FY 2020 budget spends 97.3% of projected revenue (they can spend 99%) and leaves a projected ending balance of \$300 million.

> **Restoring the rights of felons to vote was tabled** for the year but Speaker Upmeyer was confident on WHO Radio that it would be accomplished next year after questions of restitution and concerns that certain violent felonies (rape, murder, kidnapping) are included are addressed.

> **Future Ready Iowa policy was passed last year and this year was appropriated \$14 million.** The goal of these funds is to speed up the process to help students and those changing fields to fill in the skills gap in Iowa through last dollar scholarships and training programs.

> **News Articles:**

- > [Gazette: Iowa Lawmakers Adjourn In Marathon Finale](#)
- > [Gazette: Here's How Key Issues Fared In The 2019 Legislature](#)
- > [Register: Six Things You Need To Know About Iowa's](#)



[2019 Legislative Session](#)

- > [Legislature Met Governor's Request For Flood Aid](#)
- > [Governor Still Reviewing Bills From Just Ended Legislative Session](#)
- > [Six Under-The-Radar Actions Taken in 2019 Session](#)

> **Our legislative agenda this year focused on three things: REPLICA, Essential Service, and Training & Recruitment.** We made progress on all three fronts. Training and Recruitment efforts are being done in rule and we are monitoring Future Ready Iowa and other initiatives to recruit and train potential EMS employees. The others had more direct legislative action this year:

1. > REPLICA Passes! The Recognition of EMS Personnel Licensure Interstate CompAct (REPLICA) is the only national multi-state compact for the Emergency Medical Services profession. Once the EMS Compact is operational, qualified EMS professionals licensed in a "Home State" would be extended a "Privilege To Practice" in Remote States for qualified circumstances. The REPLICA interstate compact bill passed both chambers in Iowa unanimously in the final days of the legislative session. A special thank you to Rep. Klein for introducing the bill in the House Public Safety Committee. As chair, he introduced the bill as a committee bill and was extremely helpful getting it to the floor of the House. Thank you to Rep. Jeneary and Senator Chapman for floor managing the bill in both chambers. A special thank you to Senator Chapman for helping navigate some last-minute challenges and for standing up for EMS and helping ensure Iowa is not

left behind when it comes to industry standards in workforce recruitment, reciprocity, and background checks.

2. > Property Taxes - The Iowa Legislature passed a property tax bill that would limit property tax increases for residential property to 2% with mechanisms in place to raise the tax further with public input and a vote of local government. IEMSA remained neutral in the discussion for two primary reasons: First, our number one priorities this year were REPLICA and conversations on essential services. Despite REPLICA passing unanimously once it got votes, we needed an all-hands-on-deck approach to ensure it passed both chambers this year. Secondly, there were conflicting messages about its impact on pensions. With IPERS coming out and saying that it had no impact on pensions, both chambers poised to pass the bill, and no one articulating the potential dangers to contributions and the pension systems overall, opposing the bill was not deemed to be prudent. It seems the potential impact on pensions stems more from overall staffing levels than contributions from individual members. We'll have to watch as this tax change takes affect and determine if we need to weigh in on potential changes or adjustments.

3. > Essential Service - IEMSA's top priority moving forward will be helping steer the conversation on EMS as an essential service. Although we all want the same thing, there are multiple directions and innumerable variables. IEMSA has, in the past, worked on a township taxation idea that would allow small towns and townships to declare EMS an essential

service and levy for that service. There are some potential downfalls stemming, primarily, from tax bases that may not be able to support this micro-essential-service approach. This year, we have partnered with the Iowa Hospital Association in advancing a bill that would allow counties to declare EMS an essential service, develop a county-wide plan that addresses all aspects of EMS service, requires public input, and a vote of county supervisors. It is the best plan we have seen to date and we are committed to carrying on the conversation both in the interim and next legislative session.



Replica Bill Signing Ceremony. —Left to Right: **Front Row**- IFA Lobbyist John Pederson, Board Member David Filipp, Gov. Kim Reynolds, Lt. Gov. Adam Gregg, IEMSA President Mark Sachen, IEMSA Board Member Gary Merrill. **Back Row:** IEMSA's NAEMT Representative Tony Sposeto, IDPH Bureau of EMS Chief Rebecca Curtiss, Division Director at Iowa Department of Public Health Ken Sharp

100% Cloud-based End-to-End EMS Software



Make a change for the better with the industry's
ONLY fully-hosted, cloud-based software for
end-to-end patient-cycle management.



All resources on a
single screen



Access anywhere,
on any device



Easy transition,
minimal downtime,
first rate technical support



Fully integrated
clearinghouse

Learn how the Cloud can make your life better. Visit mptechnologies.com/voice today.



IEMSA
Iowa Emergency Medical Services Association

OUR FALLEN HEROES MAY 18TH, 2019

WEST DES MOINES STATION #19 • 8055 MILLS CIVIC PARKWAY



JAY
ALAN ALBAUGH

Jay Albaugh, 56, of Waverly, passed away on July 12, 2018

of idiopathic pulmonary fibrosis. Jay was born on September 22, 1961 the son of Ernest and Nancy Albaugh. He married Shelly (Weber) Albaugh in 1985. They had two daughters Sarah (Tyler) Kramer and Melissa (Tyler Garcia). Jay also enjoyed being a grandpa to his two grandsons, Harrison and Calvin.

Jay received his EMT certification from Kirkwood Community College in 1983, and paramedic certification from the University of Iowa in 1984. He started his career in the EMS field working for an Ambulance Service of Baton Rouge, Louisiana for two years. He then accepted a paramedic position with East Baton Rouge Parish EMS from 1985-1994. Jay moved to Iowa in 1995 and continued his passions with the Waverly Health Center where he worked until 2011 as a Paramedic as well as an Ambulance Manager. Jay also served as a paramedic for Franklin General Hospital from 2011-2012. From 2012-2018 he worked for Iowa Specialty Hospital in Belmond where he retired due to his health.

Jay had many accomplishments in his career. He was a Field Training Unit Commander for East Baton Rouge EMS. Jay was an EMT and a PHTLS instructor. He received a Medal of Honorable Service for starting a Special

Operations Team that responded with the Baton Rouge Police SWAT team. This team was also trained in rope rescue, hazmat, and auto extrication. Jay received a Certificate of Commendation from the City of Baton Rouge for outstanding courage in rescuing a woman and a child who were endangered by downed and arcing power lines. He was Employee of the Year for Iowa Specialty Hospital in 2015.

During Jay's 35 years working in the EMS field, he provided quality care to his patients using his ability to stay calm even during the toughest situations. Former colleagues have stated, "If Jay was working we knew that whatever situation came up, everyone would be in good hands." His co-workers also appreciated his ability to add fun and humor to the workplace. He was definitely known for making others laugh. Jay was personable and easily made connections. This was a huge part of what made him great at his job; his patients felt safe and cared for.



MARK
E. LEWERKE

Mark was born Dec. 1, 1958, in Britt, Iowa and graduated from Garner-Hayfield

High School in 1977 and Mercy Des Moines in 1986 as a paramedic. He was united in marriage to JoAnn C. Miller and they made their home in Garner, Spirit Lake, Prescott, Az. and Chino Valley, Az.

He spread his 32 year Emergency Medical Service career amongst Garner Volunteer Ambulance Service, Dickinson County Memorial

Hospital, and finally with Clear Lake Fire Department as a Paramedic/ Fire Fighter 1, until his death. The friendships he acquired with the EMS, Fire, and Law Enforcement realm were very special to him, often talked about and a great source of joy in his life. He shared countless conversations and cups of coffee with these great men and women, who also were so giving of themselves to their careers. He always said that being a Paramedic is not a job, but a "calling."

His faith in the Lord was very important to Mark. He loved carpentry and worked as a general contractor for over 35 years. He proudly built over 50 homes and was in the process of remodeling his personal home when he passed. Mark was always there to help his family and friends with carpentry projects, building race cars or whatever else was needed.

Mark's favorite hobby was auto racing from the days of watching his father race. Two of his most memorable racing events were getting Rookie of the Year in 1990 and watching his brother win the 2006 IMCA Super Nationals in Boone, Iowa. He enjoyed spending time with his granddaughters, riding his Harley, learning to play guitar, morning coffee with the guys, annual trips to Fort Myers Beach with JoAnn, and truck rides with Reagan (his dog).

He is missed deeply by his family, EMS family, and a full community of friends and neighbors far and wide.



DANIEL
T. LINDSAY

Daniel Thomas Lindsay passed away on March 30, 2019. He was born in San Gabriel, California on April 21, 1969 to Jack and Mary Lindsay.

Dan grew up in Southern California and moved to Nebraska with his parents after high school. Dan has worked in EMS since 1988 and served communities in Iowa, Nebraska, and Missouri as a paramedic since 1990.

Dan is survived by his mother, Mary Lindsay of Grimes; wife Robin; son Tyler and daughter Bobbi Liston; grandchildren Eric Foster of Covington, GA and Renea Foster of Dallas Center, IA.; and nephew, Mike Thomas of Nebraska City. He is preceded in death by his father Jack Lindsay and his grandparents Roy and Maxine Thomas.

Dan lived a full life and never missed an opportunity to have fun. Family, friends, and coworkers will forever remember his jokes, smiles, and endless conversations.



KENDRA
FAY LUZE

Kendra Fay Luze, age 58, of Aplington, Iowa, was born the daughter of Reuben Buddy and Lucille Beryl (Gross) Hansen on August 11, 1959, in Huron, South Dakota, along with her triplet brother and sister, Kevin and Karen. She graduated from the Paullina School in 1978 and continued her education at Western Iowa Community Tech College in Sioux City, Iowa, for Police Science. Through the years Kendra worked

as a CNA at Maple Manor and then in the ER at Sartori Memorial Hospital in Cedar Falls, Iowa, for 30 years. In 1985 Kendra became an EMT for the Aplington Ambulance and four years ago she became an AEMT (Advanced Emergency Medical Technician). Kendra was Aplington's only EMT. She loved helping people. Even while she was fighting for her own life against colon cancer. Kendra was a member of the First Reformed Church in Aplington. She enjoyed going camping and fishing and in her spare time, she liked crocheting and gardening. Her biggest joy in life was the day they adopted Travis.



JUDY
OTT

Judy Ott was one of the founding members of Winneshiek County EMS. She served on the executive board as Vice President, Secretary and Treasurer. She was an active member of the South Winneshiek Area First Responders for the Calmar, Spillville and Fort Atkinson area. Judy was also a member of the Fort Atkinson Fire Department. She enjoyed volunteering and was an avid bicyclist completing RAGBRAI thirteen times. Judy was also a CPR instructor for many years. Teaching many students each year. Judy was born Judith Agnes Schmitt on October 17, 1950 to Linus and Veronica (Winter) Schmitt in Decorah, Iowa. She attended St. John's Catholic School in Fort Atkinson and graduated from Turkey Valley High School in 1968. She studied business at Mankato Community College. She married Roger Ott on August 14, 1971 at

St. John's Catholic Church in Ft. Atkinson, IA. and moved to the farm that they enjoyed together for 47 years. Judy worked at Winneshiek Medical Center for 28 years and was a Winneshiek County first responder for 35 years. In recent years, she worked at the Sunflower Daycare in Decorah and found her true passion working for the Christ Our Hope Parish Cluster Office. In her spare time, she enjoyed quilting and sewing and many were privileged to receive her beautiful work. She was an avid cyclist and participated in RAGBRAI for thirteen years making numerous friends along the way. Judy's most cherished time was spent with her children and grandchildren.



ANDREW
R. MILLER

Andrew "Andy" Miller joined our little volunteer ambulance service in 2013. Andy had a strong sense of community, growing up locally and knowing the area made him an instant asset to our group. His warm personality was only outshined by his caring heart. Lou Gehrig's Disease (ALS) took him from the field in 2017 but he remained a strong presence in our service, providing support and leadership at every opportunity. Andy never wanted the spotlight, only to help others. Andy was a superhero.

*Always Missed.
Never Forgotten.*



EMS SUPPLIES

RECENT DELIVERIES



Contact Danko For All Your Emergency
Vehicle And Equipment Needs!

DANKO

FIRE | RESCUE | EMS



Demers Ambulances Exclusive Iowa Distributor



P-0744
Griswold, Iowa

Demers Ambulances is one of the largest, most trusted ambulance design & manufacturer in the world

The Most Affordable Gas Monitors In The Fire & EMS Service!

- 1100 CO Monitor**
 - CO Monitor Only
 - Part: AMSAI-1100-V2
- 1200 CO Monitor w/LCD**
 - CO Monitor with Sniff™ Technology
 - Part: AMSAI-1200-V2
- 1201 CO & Methane Monitor w/LCD**
 - CO & Methane Monitor with Sniff™ Technology
 - Part: AMSAI-1201-V2



Dysart, Iowa (P-0315)

Danko Is Also Your Dealer For Maintainer Custom Bodies

Danko Emergency Equipment • Snyder, Nebraska • 866-568-2200 • www.danko.net • trucksales@danko.net

GET IN ON THE BEST

WE ARE A PROUD DEALER FOR

McCOY MILLER
REV GROUP



MCCOY MILLER TYPE I AMBULANCE #A304
SPECS • PHOTOS • VIDEO TOUR • ALEXISFIRE.COM

CONTACT US TODAY FOR MORE INFORMATION

ALEXIS
DRIVEN TO SERVE.

ALEXISFIRE.COM | 1-800-322-2284 |





WHY SHOULD MY SERVICE BELONG? AFFILIATE MEMBERSHIP

BY LINDA FREDERIKSEN
SE REGION IEMSA BOARD MEMBER

For me, membership is a sense of pride and a sense of belonging for a great group of EMS professionals and a way to give back to make EMS stronger and better in Iowa. Membership is valuable and critical for any organization. In this economy it is often hard to justify spending money on professional organization fees with shrinking budgets. Yet, that membership can provide great value to you, your employer, and IEMSA.

IEMSA was established in 1987 and has been advocating for EMS on the Hill passionately ever since. No matter your level of service, type of department, **IEMSA has served Iowa EMS resulting in:**

- > **increased revenues** for your service with increases in the Medicaid Reimbursement rates.
- > **doubling the tax credit for volunteer** providers by increasing the tax credit to \$100.
- > **an education event program that brings national level speakers to Iowa.** Offering an affordable education and a great way to network and improve the level of care by sharing ideas between providers and services.
- > **very deep discounts on equipment and supplies for our Affiliate Members** through our Group Purchasing program.

We have identified the need to address and educate the public about EMS and its role in public safety across our state. The public needs to know who we are and how they can help us better serve them. We believe if Iowans know the struggles of our dedicated EMS providers, they will stand with us to move EMS to "Essential Service" status in Iowa. This status would secure, protect and improve EMS in ways we can only dream of right now. We will be working on this issue in the coming years. Your support will help make this happen.

There are plenty of other associations, such as NAEMT, IAFF, AAA, NAEMSP, NAEMSE, and many more, but **only IEMSA is geared towards focusing on EMS issues in Iowa that affect all of us personally and professionally. Join the 188 Affiliate Organization Members today--a full list of those members is on page 12.**

JOIN TODAY--Complete the Affiliate Membership Application on Page 13, or Contact Lisa Arndt, Office Manager at 515-225-8079 | administration@iemsanet.net | Go to http://iemsanet.net/member_account.htm For step-by-step details --follow the instructions

WHAT ARE THE BENEFITS?

- > **Job Openings** at your service can be posted on our Job Posting Area of our Website--just complete the application at this link-- <http://www.iemsanet.net/employment.htm> when you have an opening--and we will post it for you. Your service must be an active member to post. There is no limit on the number of postings or how long the opening is posted. We understand our Job Board is, more effective, and less expensive than other job sites, like monster.com and other job sites.
- > **(1-3) FREE IEMSA Individual Membership(s)** for a provider from your organization--(\$30-\$90 Value based on membership level)
- > **25% off an Exhibit Booth** at the IEMSA Conference & Trade Show
- > **(1) FREE Seat in the Pre-Conference Leadership/Management Workshop** at the Annual IEMSA Conference & Trade Show--held in Des Moines every November-- (\$120 Value)
- > **Deep Discounts on Equipment and Products** --Your service/organization will be automatically enrolled in the Group Purchasing Program-- once you're an affiliate member of IEMSA, within 5-7 days from purchase of your IEMSA membership Boundtree Medical will activate your account to apply IEMSA discount levels to your account. This benefit alone will more than re-pay your membership dues with the discounts you see, beginning with your first order. You will enjoy FREE Shipping as well.



IEMSA
Iowa Emergency Medical Services Association

MEMBERSHIP UPDATE

MEMBERSHIP TOTALS
AS OF AUGUST 2019:



1485

+



188

+



25

=

1698



A HUGE THANK-YOU TO OUR AFFILIATE MEMBERSHIP

THESE IEMSA **AFFILIATE MEMBER** ORGANIZATIONS ARE MAKING A DIFFERENCE.
YOU CAN TOO--**BE A LEADER JOIN IEMSA TODAY!**

Adair County Ambulance
Adams County Ambulance
Algona EMS
Anamosa Area Ambulance Service
Andover Ambulance Service
Ankeny Fire Department
Area Ambulance Postville
Atkins First Responders
Beaman Conrad Emerg Response Team (BCERT)
Bellevue Ambulance Service
Belmond Ambulance Service
Bernard Rescue Unit, Inc.
Bettendorf Fire Department
Blairstown Ambulance
Boone County Hospital
Boone Fire Department
Breda Area Ambulance
Buffalo Center Vol Amb Service
Burlington Fire Ambulance
BVRMC Ambulance
Calhoun County EMS
Camanche Fire Department
Care Ambulance
Carlisle Fire Rescue
Carroll Co Ambulance Service
Cedar Rapids Fire Department
Center Point Regional Ambulance
Cherokee County EMS Association
Chickasaw Ambulance Service, Inc.
Clarinda Regional Health Center
Clarion Ambulance Service
Clay County EMS Association
Clinton Fire Department
Clive Fire Department
Clutier 1st Responders
Colfax Fire Department
Community Ambulance Service of Preston
Council Bluffs Fire Department
Crescent Rescue
Dallas County EMS
Davenport Fire Department
Davis County Hospital
Defiance Fire & Rescue
Delaware Township Fire Dept
Denver Ambulance Service
Des Moines Fire Department
Dunkerton Ambulance
Dysart Ambulance Service
Earlham Rescue
Eastern Iowa Community College
Eldora Emergency Med Service
Ely Volunteer Fire Department
EMERSON VOLUNTEER RESCUE
Essex Fire & Rescue
Farmington EMS
Forest City Ambulance Service
Fort Dodge Fire Rescue
Garner Vol Ambulance Service
Granger Community Ambulance
Granville Fire & EMS
Gravity Rescue
Greene County Ambulance
Griswold Fire & Rescue

Hancock Fire & First Responders
Hartley Ambulance
Hawarden Ambulance
Hawkeye Community College
Henry County Health Center - EMS
Hiawatha Fire Department
Humboldt County EMS Alliance
Independence Fire Department
Indian Hills Community College
Indiana Township First Resp
Indianola Fire Department
Iowa Central Community College
Iowa City Fire Department
Iowa County Ambulance
Iowa Falls EMS
Iowa Lakes Community College
Iowa Valley Community College
Jasper County Emergency Management Agency
Jefferson Monroe Fire Dept. (Swisher)
Johnson County Ambulance
Keokuk County Ambulance Service
Key West Fire and EMS
Kingsley Ambulance Service
Kirkwood Community College
Knoxville Fire Department
La Porte City Ambulance
Lake Mills Ambulance Service
Lakes Regional Healthcare
Lansing EMS
Le Mars Ambulance Service
Le Mars Fire-Rescue
Lee County EMS Ambulance
LeGrand First Responders
Lewis First Responders
Lifeguard Air Ambulance
Lisbon Fire and Rescue
Lisbon Mt Vernon Ambulance
Louisa County Ambulance
Lowden EMS
Lucas County Health Center
Madison County Ambulance
Malvern Volunteer Rescue Inc
Martensdale Fire Dept
Mary Greeley Medical Center
Mason City Fire Department Ambulance
Mechanicsville Ambulance
Mediapolis Community Ambulance
MEDIC EMS
Medivac Ambulance Rescue Corp
Menlo Fire & Rescue
Mercy Air Med
Mondamin Fire & Rescue
Monticello Ambulance Service
Morning Sun Ambulance Service
Muscatine County EMS Association
Muscatine Fire Department
New Hartford Ambulance
New Sharon Fire & Rescue
Newhall First Responders
Newton Fire Department
Nora Springs Volunteer Ambulance
North Liberty Fire Department
North Sioux City Fire and Rescue

Northeast IA Community College
Northwest Iowa CC
Norwalk Fire Department
Norway Fire & Rescue
Orange City Area Health System
Osceola County Ambulance (Sibley Amb)
Palo Alto County Ambulance
Paramount EMS
Pella Community Ambulance
Pleasant Hill Fire Department
Pocahontas Ambulance Service
Rake First Responders
Regional Medical Center
Remsen Ambulance Service
Rock Valley Ambulance
Saylor Township Fire Department
Shelby County Emergency Services Association
Shelby Fire & Rescue
Sherrill Fire Department
Sioux Center Ambulance
Sioux City Fire Rescue
Slater EMS
Southern Appanoose County First Responders
Southwestern Community College
St. Mary's Fire Department
State Center EMS
Story City First Responders
Strawberry Point Ambulance Service
Sumner Emerg Medical Services
Superior Ambulance
Tama Ambulance Service
Taylor County Ambulance
Tipton Ambulance Service
Titonka Ambulance Service
Traer Ambulance Service
Tripoli Ambulance Service
Tri-State Regional Ambulance Service, Inc.
UnityPoint Health - Marshalltown Area
Paramedic Service
University of Iowa Hospitals and Clinics
Urbandale Fire Department
Van Buren Ambulance Service
Van Horne First Responders
Veterans Mem.Hosp.Ambulance
Villisca Ambulance Service
Virginia Township Fire and Rescue
Wapello Community Ambulance
Washington Co Ambulance
Waterloo Fire Rescue
Waterville Ambulance Service
Wellman Volunteer Ambulance
West Des Moines EMS
West Liberty Vol Fire Dept
Western Iowa Tech Community College
Westgate Fire & Rescue
Wheaton Franciscan Healthcare
Wilton Fire and EMS
Windsor Heights Fire Department
Winneshiek County Emergency Management
Winneshiek Medical Center Ambulance
(Members as of -- 9/11/2019)



IEMSA
Iowa Emergency Medical Services Association

AFFILIATE MEMBERSHIP APPLICATION



AFFILIATE LEVEL 1
(<50 CALLS/YEAR)

\$50/YEAR

(< 50 Calls/Year)



AFFILIATE LEVEL 2
(51-500 CALLS/YEAR)

\$100/YEAR

(51-500 Calls/Year)



AFFILIATE LEVEL 3
(501-2499 CALLS/YEAR)

\$250/YEAR

(501-2,499 Calls/Year)



AFFILIATE LEVEL 4
(2500+ CALLS/YEAR)

\$350/YEAR

(> 2,500 Calls/Year)

TO JOIN IEMSA ONLINE:

Go to http://iemsanet/member_account.htm Click the "Login Here" button. You will be prompted to log-in to your IEMSA Account to register--Usernames are set to the email address on file and everyone's temporary password is set to IEMSA2014 which is case sensitive and contains no spaces. Passwords can be reset at this time.

Don't have an IEMSA Account? click on the "Guest Registration" Link to create an account:

Once Logged-in--go to the "Online Store" tab at the top of your screen, click on the "Individual Membership" icon, add to your cart, process payment and you're now registered. You will receive a receipt and confirmation immediately by email. The payment options include: credit/debit card or select "Mail my Check". Memberships are not activated until payment is received. **Mail Checks to:** IEMSA, 5550 Wild Rose Lane #400, West Des Moines, IA 50266.

TO REGISTER BY MAIL OR FAX:

Complete this page and return with your check to: IEMSA, 5550 Wild Rose Lane #400, West Des Moines, IA 50266 -- or FAX with Credit Card Info this form to: 877-478-0926. You will receive a confirmation email once your payment is received and/or processed. If you do not receive an email--please contact the office to confirm your membership was received.

Credit Card or FAX/EMAIL AFFILIATE Membership Application:

☐ LEVEL 1- **\$50/YEAR**

☐ LEVEL 2- **\$100/YEAR**

☐ LEVEL 3- **\$250/YEAR**

☐ LEVEL 4- **\$350/YEAR**

Organization/Service Provider Name

Primary Contact Name

(Home) Address

City

State

Zip

1st FREE Individual Membership -- Email Address (mandatory)

IA EMS Certification #

All Affiliate Levels Complete --Affiliate Level 1 & 2 receive -(1) FREE Membership--Designate Here

2nd FREE Individual Membership -- Email Address (mandatory)

IA EMS Certification #

Level 3 & 4 Complete --Affiliate Level 3 receive -(2) FREE Memberships

3rd FREE Individual Membership -- Email Address (mandatory)

IA EMS Certification #

ONLY Level 4 Complete --Affiliate Level 4 Receive -(3) FREE Memberships

PAYMENT METHOD:

☐

MasterCard

☐

Visa

☐

Check Enclosed-Payable to IEMSA

Credit Card Number

Exp. Date

Name on Card

3-Digit Security Code on Back of Card



Paramedic to Bachelor of Science in Nursing

Join the high demand nursing workforce quickly and receive credit for your training and experience as a certified paramedic.

Why Mercy College?

- Receive 10 Paramedic Certificate credit hours towards your BSN.
- Complete in as few as SIX semesters.
- Classes start in the fall and spring.
- Iowa's first and only program offering a path to a BSN degree specifically designed for Paramedics.
- Flexible class schedule designed around your availability.

Visit our booth to speak
with a nursing advisor
or learn more at

mchs.edu/pm-bsn

stryker

Together
we save lives.



**Visit our website at
strykeremergencycare.com**

©2019 Stryker GDR 3337691_B



IEMSA INDIVIDUAL MEMBERSHIP UPDATE



WHY JOIN IEMSA?

BY AMY GEHRKE, NC REGION DIRECTOR & INDIVIDUAL MEMBERSHIP COMMITTEE CHAIR

IEMSA was established in 1987 and has been actively involved in EMS in many facets. No matter your level of service, type of department, or patch on your sleeve, IEMSA is here to serve you and help be your VOICE be heard in Iowa. Some join for the professional recognition and networking opportunities, while some join for the member benefits and discounted educational opportunities that are held throughout the year across Iowa. Others join for the resources, group purchasing, quarterly VOICE publication, our strong advocacy efforts, and timely member alerts through eNews. There are plenty of other associations, such as NAEMT, IAFF, AAA, NAEMSP, NAEMSE, and many more, but only IEMSA is geared towards focusing on EMS issues in Iowa that affect all of us personally and professionally.

> WHY SHOULD YOU SPREAD THE WORD ABOUT IEMSA MEMBERSHIP?

There are so many benefits with this low cost membership. The most important for any EMS provider is the \$10,000 accidental death/dismemberment policy offered to each member. In our high risk line of duty this could be a huge asset to your family. If you are a member, have you filled out your beneficiary designation? We want to make sure all families receive this benefit if needed so fill out this form ASAP. You can find the form at this link: http://www.iemsa.net/pdfs/beneficiary_form.pdf

> EDUCATION IS ANOTHER IMPORTANT BENEFIT FOR ALL MEMBERS.

You will receive a substantial discount on all IEMSA sponsored events, including our annual conference --an amazing event that is a lot of fun, offers top quality certified CE education, featuring well-known local and national speakers. In addition, you can pick up 1.0 Optional CE from our continuing education with each of two VOICE newsletters. And finally, with your IEMSA Membership you receive a 25% off (\$10 off) NAEMT dues with proof of current membership.

> IEMSA IS YOUR ADVOCATE AT THE STATE LEVEL AND LOCAL LEVEL.

Each region has representatives that you can reach out to. We have made great strides in Iowa with the legislators. Your involvement in your professional association is important to EMS. We need your voice to make important improvements in the state and national level. We can't do it without you!

There are also numerous benefits for affiliate organizations, students, retired-active individuals, corporate, and training centers memberships! To see all the great benefits please go to the IEMSA site at: <http://iemsa.net/membership.htm>

JOIN ONLINE TODAY AT: http://iemsa.net/member_account.htm For step-by-step details --follow the [instructions on the screen. NEW MEMBERS SET-UP AN ONLINE ACCOUNT CLICK HERE](#)

15

MEMBERSHIP BENEFITS OVERVIEW

	\$ 10,000 AD&D	FREE Individual Memberships	Member Discounts	DISCOUNTED EMS EQUIPMENT & SUPPLIES FROM BOUNDTREE MEDICAL	VOICE and eNEWS	25% NAEMT Discount
Student		X	X		X	X
Active Retired			X		X	X
Individual	X		X		X	X
Affiliate	n/a	X	X	X	X	X
Corporate		X	X		X	

YOUR PARTNER IN EMS



Brooke Teeselink
Account Manager
712.308.1092



Katie King
Account Manager
614.973.7348



Curaplex®
Stop the Bleed® Kits



Persys Medical
NIO®



Curaplex®
Go-PAP™ Capno Kits



ROSC-U™ Mechanical
CPR Device



FREE ONLINE CEUS
boundtree.com/university



Bound Tree



IEMSA BILLING & DOCUMENTATION CONFERENCE

BY LINDA FREDERIKSEN



A total of ninety-seven people attended the 15th Iowa EMS Association Billing and Documentation conference on April 8 & 9, 2019 at the Hilton Garden Inn in West Des Moines. Once again,

Doug Wolfberg, founding partner of Page, Wolfberg & Wirth, and one of the best known EMS attorneys and consultants in the United States, captivated those attending with all 12 required hours of comprehensive education helpful for not only billers, but EMS Providers. Many who attended this presentation possess a Certified Ambulance Coder (CAC) certification from the National Academy of Ambulance Coding; these individuals must renew this certification annually with twelve hours of continuing education, and appreciated the fact that all their mandatory and elective continuing education hours were included in this one seminar.

We added a day to our program this year-- offering Iowa EMS Services that are NOT

Billing to attend a 1/2 day of education that assisted attendees in accessing the opportunity to capture some of the funds available that billing for service brings. Doug and a team of experts covered, an Overview of the Non-Billers DATA to identify the amount of funds not captured across the state. They learned about the new federally funded GEMT program that promises to bring millions of dollars to our state. They learned the ins and outs of eligibility or this program. Closing the day Michelle Smith of PCC and Tim Furtado of AMBUpro, walked attendees through how to identify if "Billing for EMS Services" is for their Service, including the ABC's of setting up an EMS Billing System in Iowa, and how to access the benefits and pitfalls.

Wolfberg's depth of knowledge was appreciated by those attending, as well as his engaging presentation style, which kept everyone interested. Plans are already being made for next year's session in April, 2020, back in West Des Moines. Mark your calendars for April 20 & 21, 2020 this great event...you won't want to miss it!

16th ANNUAL REGIONAL EMS BILLING & DOCUMENTATION CONFERENCE

APRIL 20 & 21, 2020

**BACK AT THE
WDM HILTON GARDEN INN &
EVENT CENTER**

FREE PARKING, CLOSE TO RESTAURANTS,
SHOPPING AND MORE.



17



SUPER-LED® SURFACE MOUNT

M Series™



With a unique lens shape and patented Linear-LED® designed reflector assembly, M Series lightheads are completely illuminated for unmatched high intensity warning and low current consumption.



Authorized Managing Sales Representative:
W. Reeves & Associates
P.O. Box 477
Norwalk, IA 50211 - (515) 981-5967



Does he need a trauma center or the local hospital?



Twenty-year-old male in
a motor vehicle accident.
Airbag has deployed.

Car has significant front-end damage.
Is he bleeding internally? Hemorrhage is
the leading cause of death after injury.¹

The new trauma parameters on the ZOLL
X Series® help you accurately and quickly
assess your patients so you can feel
confident in your treatment decisions.

Insight for informed decisions.
www.zoll.com/trauma

ZOLL®

¹Acosta JA, et al. *Journal of the American College of Surgeons*. 1998;186(5):528-533.



UNIVERSITY OF IOWA
HEALTH CARE
Emergency Medical Services
Learning Resources Center
uihealthcare.org/emslrc

1-800-272-6440



AirCare

specialty emergency vehicles

BRAUN-NW inc.
A sense of duty to our customers, and the public they serve



EMERGENCY VEHICLES

www.braunnw.com

150 North Star Dr. PO Box 1204 Chehalis, WA 98532
DTF: 800.245.6303 TEL: 360.748.0195 FAX: 360.748.0256



EMS BUREAU UPDATE

BY DIANE WILLIAMS-Trauma Program Manager

Iowa Department of Public Health-Bureau of Emergency and Trauma Services



MISSION: SAVING RURAL EMS

SYSTEM STANDARDS AND SYSTEM DEVELOPMENT INITIATIVES

An Emergency Medical Service (EMS) provides emergency medical care to individuals that experience illness or injury. Emergency medical response requires a coordinated effort that involves multiple responders and agencies working in concert to provide a seamless response to ensure that resources are available to meet the needs of the emergency. This coordinated effort represents the grass roots of system development.

Rural agencies continue to struggle to find, train and keep active volunteers and funding to maintain and enhance EMS in our rural communities. Using system standards and system development principles, the Bureau of Emergency and Trauma Services (BETS) along with the public health agencies

and hospitals in the EMS and preparedness and service areas are working to assist EMS to minimize the administrative burdens that challenge the rural service programs.

The rural services are critical to the overall system of care in our state. The system standards and system development initiatives are being introduced through the EMS and Preparedness service areas to coordinate efforts to reduce inefficiency and redundancy in administration, training, education and overall costs of operation.

Stay up-to-date and get involved by attending these critical meetings:

- Service Area/Coalition Full Meetings
- Service Area/Coalition EMS Sub-Committee Meetings
- EMS Advisory Council Meetings

BETS has dedicated EMS field coordinators to assist EMS in understanding and implementing system development plans. Contact Merrill Meese at Merrill.Meese@idph.iowa.gov or Michelle Fischer-Short at Michelle.Fischer@idph.iowa.gov for additional information.

Join the Team!

Be a part of the fastest growing medical transportation company in the region. Midwest Medical is seeking to hire people who share our energy, enthusiasm and commitment to the highest level of patient care.

See current openings in your area like:

- Emergency Medical Technicians (EMTs)
- Paramedics
- Station Managers
- Fleet Maintenance
- Dispatchers
- Flight Medics
- Flight Nurses
- Pilots

THIS COULD BE
YOU!



APPLY NOW!

midwest-med.com/careers

For more info: 833.526.5319
joinourteam@mwmtc.com



Midwest Medical™
Medicine in Motion

833.526.5319 · midwest-med.com

YOU ARE THERE FOR OTHERS PCC IS HERE FOR YOU

No matter what size service you have, our staff continues to provide the highest level of service to ensure your success for years to come. PCC is dedicated to providing the highest quality coding, billing and account management services for a low cost to Ambulance Providers.



PCC has assembled a dedicated team of billing and collection professionals from the ambulance, fire, and medical fields to provide a dependable service that far exceeds our competitors. Our expertise, commitment, and processes are proven to be at the forefront in our industry. It is said that, "PCC is the only service that we trust" for complete and accurate Fire & EMS billing across the Midwest Region.

PCC
AMBULANCE BILLING SERVICE

Contact us to find out how to
INCREASE YOUR REVENUE UP TO 35%
over your current in-house biller.

CALL 877-882-9911 OR VISIT PCCFORME.COM

REGISTER NOW!

IEMSA > THE VOICE FOR POSITIVE CHANGE



IOWA EMERGENCY MEDICAL SERVICES ASSOCIATION



IEMSA^{30TH ANNUAL} CONFERENCE & TRADE SHOW

IOWA EVENTS CENTER • DES MOINES, IA • NOVEMBER 7-9, 2019

HOTEL & VENUES

ONLINE RESERVATIONS --To Reserve your room at our block rate online go to: www.iemsa.net/conference.htm and click on the link in the right sidebar under "2019 Conference Hotels."

HILTON DES MOINES

435 Park St., Des Moines

(855) 271-3617

MUST ASK FOR THE IOWA EMS ASSOCIATION Group Room Block & Group Code: IEM4 for a discounted rate of \$143/sing/dbl+ tax/night

DISCOUNT CUT OFF DATE:

October 17, 2019.

Public Parking Rates, located one block south at the corner of 5th Ave. and Watson Powell Jr. Way.

Or Valet Parking at \$25/nt.

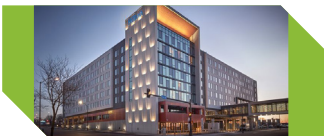

HOLIDAY INN

1050 Sixth Ave., Des Moines

515-283-0151

MUST ASK FOR IEMSA Group Room Block & Group Code: IEMSA for a discounted rate of \$107+ tax/night for single/double; \$117 King with Sofa

DISCOUNT CUT OFF DATE:

October 23, 2019

Free Parking, Free Event Center Dedicated Shuttle Service and includes breakfast (see reservation for details)



COMFORT INN & SUITES (previously Quality Inn)

929 3rd Street, Des Moines

515-282-5251

MUST ASK FOR IEMSA Group Room Block & Group Code: IEMSA for a discounted rate of \$110+ tax/night for king/double.

DISCOUNT CUT OFF DATE:

October 17, 2019

Free Parking



EMBASSY SUITES DOWNTOWN

101 E. Locust St., Des Moines

(515)-244-1700

MUST ASK FOR THE IOWA EMS ASSOCIATION Group Room Block & Group Code: EMS for a discounted rate of \$147/sing/dbl+ tax/night

DISCOUNT CUT OFF DATE:

October 17, 2019

Public Parking Garage at Prevailing Rates; Valet Parking available \$23/day



VENUE: IOWA EVENTS CENTER

COMMUNITY CHOICE CREDIT UNION CONVENTION CENTER & HYVEE HALL C

730 3rd St,
Des Moines, IA 50309

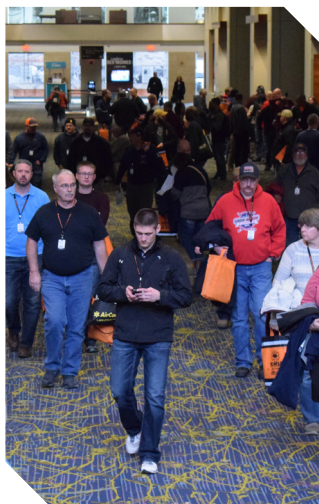

IEMSA EXHIBIT HALL

HYVEE HALL C

FEATURING:
THE TOOLS OF YOUR TRADE

EXHIBIT HALL HOURS:

THURS. NOV 7TH

11:15- 6PM
WELCOMING RECEPTION
STARTS AT 4:30PM

FRI. NOV 8TH : 9:15AM-5:40PM

SAT. NOV 9TH : 9:00AM-1:00PM

IEMSA CONFERENCE GIVE-AWAY WINNERS ANNOUNCED

DRAWING HELD ON THURSDAY
OPENING RECEPTION AND DURING
BREAKS FRIDAY AND SATURDAY. **MUST
BE PRESENT TO WIN**



21

At Foster Coach Sales: **TRUST COMES STANDARD**



When you purchase an ambulance from Foster Coach Sales, you get a trusted partner with built-in credibility and expertise to guide you through your purchase. Trust is *never* a given, it has to be earned. With a 62-year history of sales and service to EMS services in the Midwest and beyond, Foster Coach has risen to the top by earning the trust of the providers it has served for several decades.

If you are a Foster Coach customer, we sincerely thank you for your past and present support. If you are not a Foster Coach customer, we would be honored if you would allow us the opportunity to **earn** your trust.

**SALES
SERVICE
PARTS
REMOUNTS**

Our entire staff is pleased to represent some of the most respected and recognized names in the ambulance industry. Let us show you how trust is never an option. It truly is a standard.

Call us today to schedule an on-site demonstration to learn more about the features and benefits of owning an EMS vehicle manufactured by the most recognized leaders in the emergency vehicles industry.



We feature these industry-leading brands:



903 Prosperity Drive • Sterling, IL 61081 • **1.800.369.4215**

www.fostercoach.com



Check us out on Facebook®

American Owned



American Made



Committed to providing the best emergency vehicles with the best service to our customers.



PRE-CONFERENCE WORKSHOPS THURSDAY, NOVEMBER 7, 2019

WATCH THE IEMSA.NET WEBSITE
for the full course descriptions on
the Registration Form.

FORMAL & OPTIONAL CE's APPLIED FOR

7:15 AM REGISTRATION OPENS

8:00 AM-4:30 AM

FULL DAY PRE-CONFERENCE WORKSHOPS

- ★ **CRITICAL CARE PARAMEDIC (CCP) REFRESHER**
- ★ **ACLS-EXPERIENCED PROVIDER -CCP DIDACTIC AND HANDS-ON COURSE (LIMIT 24 STUDENTS)**
- ★ **NAEMT SAFETY COURSE:** (A minimum of 15 students needed to present this workshop-full refunds will be issued if this course does not meet the minimum)
--DAN MILLER, CHERYL BLAZEK + BRIAN KOSTER
- ★ **DISASTER MANAGEMENT EMERGENCY PREPAREDNESS** --UNITYPOINT DSM IMMC

8:00 AM - 11:15AM -- 1/2 DAY MORNING WORKSHOPS

- ★ * **SERVICE DIRECTOR/MEDICAL DIRECTOR WORKSHOP**
--BRAD VANDELUNE/STEVE VANNATTA
(LEADERSHIP/MANAGEMENT TRACK-AM SESSION)

12:15 PM - 4:30 PM 1/2 DAY AFTERNOON WORKSHOPS

- ★ * **CLINICAL GUIDELINES AND SCOPE OF PRACTICE**
--STEVE MERCER AND DR. DAVID STILLEY
(LEADERSHIP/MANAGEMENT TRACK-PM SESSION)
- * **"WHERE'S WALDO?" MISSING MANAGERS. MISSING EMPLOYEES. MISSING LEADERS.**
--BRUCE EVANS, MPA, CFO, NRP, SPO, Fire Chief at the Upper Pine River Fire Protection District, NAEMT President-Elect
This program will discuss the recruitment and retention of EMS providers. The responsibility and action of management and/or leadership in shaping the workforce will be discussed. Facilitating a "just culture" and creating a positive work environment with consistency and creating a WOW environment.
(LEADERSHIP/MANAGEMENT TRACK-PM SESSION)

*IEMSA Affiliate Members: 1-Person may attend the Leadership/Management Pre-Conference AM and PM sessions at no charge--Membership status will be verified. Indicate "FREE" or Online apply Promo Code AFF-Leader19

LUNCH AND SPECIAL EVENTS

THURSDAY 11/7 -- NEW! EXHIBIT HALL HOURS 11:15 - 6 PM

NEW THIS YEAR! LUNCH IN THE EXHIBIT HALL (11:15-12:15)

--HYVEE HALL BBQ, MEXICAN FOOD VENDORS AND SEATING WILL BE AVAILABLE

--Bring your raffle tickets to the IEMSA Booth # 65 in the exhibit hall -- drawings begin at 4:30pm

VENDOR HALL /WELCOMING RECEPTION

4:30 - 6:00 PM - WELCOMING RECEPTION

--EXHIBIT HALL --HYVEE HALL C

- COMPLIMENTARY FOOD AND BEVERAGES.
- LARGE DISPLAY OF THE TOOLS OF YOUR TRADE
- VENDOR RAFFLE GIVEAWAY DRAWINGS BEGIN

SIT-DOWN LUNCH PRESENTATIONS

DURING LUNCH FRIDAY Presentation by

- **Supporting Heroes Non-Profit Organization**

DURING LUNCH SATURDAY --

- **The Annual IEMSA Awards Ceremony**

NOW IS YOUR CHANCE TO DROP OFF YOUR RAFFLE TICKET FOR A CHANCE TO WIN PRIZE! DRAWINGS WILL BE IN

THE EXHIBIT HALL STARTING ON THURSDAY AT 4:30PM DURING THE WELCOMING RECEPTION AND AGAIN ON FRIDAY AND SATURDAY BREAKS ONLY. YOU MUST DROP OFF YOUR RAFFLE ENTRY CARDS IN THE RAFFLE BAG AT THE IEMSA BOOTH. YOU MUST BE PRESENT TO WIN.

DRAWINGS WILL BE HELD:

- THURSDAY NIGHT -- 4:30PM - 6:00PM
- FRIDAY AM BREAK -- 9AM - 9:45AM
- FRIDAY PM BREAK -- 3:15PM - 3:45 PM
- SATURDAY AM BREAK 9:15AM - 9:45AM

IMPORTANT NOTE:

NO RAFFLE DRAWINGS DURING LUNCH

7:30PM - 11PM

"GATHERING PLACE EVENT" -- "BEER CAN ALLEY" ON COURT AVE DETAILS BELOW.

THURSDAY NIGHT FUN
GATHERING PLACE EVENT : 7:30-11P

LOCATION: BEER CAN ALLEY - NOV. 7TH
(NO COVER FOR CONFERENCE ATTENDEES)
216 COURT AVE. • DES MOINES
JUST A 10 MINUTE WALK FROM
THE IOWA EVENTS CENTER



DANCING, DRINK SPECIALS, AND A WHOLE LOT OF FUN.



SPONSORED BY





FRIDAY NOVEMBER 8, 2019 SCHEDULE AT-A-GLANCE PLANNER

WATCH THE IEMSA.NET WEBSITE
for the full course descriptions on
the Registration Form.

★ = FORMAL EMS CEH + NURSING Contact Hours
⓪ = OPTIONAL EMS hours
(Hours applied for finalized at Conference)

6:45 AM **REGISTRATION OPENS**

7:45 AM - 9:00 AM --KEYNOTE SPEAKER GENERAL SESSION **BALLROOM**

★ **THREE WAYS TO GET THERE** —BILL JUSTICE, MIKE GRILL, GARY WIEMOKLY

9:00 AM - 9:45 PM

- **BREAK IN THE EXHIBIT HALL** --HYVEE HALL C
Give-Away Drawings Continue and Refreshments and a treat will be served in the exhibit hall for this break.
- **YOUR CHANCE TO DROP OFF YOUR RAFFLE TICKET**
"DROP OFF YOUR RAFFLE ENTRY CARDS IN THE RAFFLE BAG AT THE IEMSA BOOTH #65 IN THE EXHIBIT HALL."

9:45 AM - 10:35 AM

- ★ **NEURO EMERGENCIES** --DR. JOSHUA PRUITT
- ★ **SURVIVING IN THE CROSS HAIRS : RESPONSE TO ACTIVE SHOOTERS** --BILL JUSTICE
- ★ **PEDIATRIC ABUSE: A CASE STUDY** --CATHERINE DEPOOLE
- ★ **NATIONAL EMS REFRESHER TRACK**
HEMORRHAGE CONTROL + FLUID RESUSCITATION --REUBEN FARNSWORTH

10:45 AM - 11:55 AM

- ★ **10 WAYS TO RUIN YOUR EMERGENCY SERVICE ORGANIZATION (ESO) OR YOUR LIFE** --DON COX
- ★ **THEY'RE JUST SO SWEET! CHILDREN WITH DIABETES** --GARY WIEMOKLY
- ★ **TOO MUCH. TOO LITTLE. TOO LONG. THE SCIENCE OF CARDIAC ARREST RESUSCITATION** --MIKE GRILL
- ★ **NATIONAL EMS REFRESHER TRACK : FIELD TRIAGE REVIEW** --REUBEN FARNSWORTH

NOON - 1:00 PM

- **Lunch is also available at the** FOOD VENDORS (BBQ, Mexican)

3:45 PM - 5:00 PM -- **KEYNOTE SPEAKER--GENERAL SESSION - BALLROOM**

★ **SEPSIS AND EMS THE SOUTH DENVER EXPERIENCE** —MIKE GRILL

8:30 PM - 11:30 PM — ★ **JOHNNY HOLM BAND --IS BACK! IT'S A DANCE PARTY** ★

— **HELD AT THE HILTON DOWNTOWN DES MOINES**
DES MOINES (435 PARK ST. - DES MOINES)

LIVE MUSIC IS BACK AND SO IS "THE JOHNNY HOLM BAND"-- SPONSORED BY **Air Methods**.

You earned it--a night of fun and relaxation. This event is FREE to all registered conference attendees.

PLEASE JOIN US FOR fun, dancing and more. Registered attendees admission is included.

IN THE EXHIBIT HALL

SIT-DOWN LUNCH --Presentation by **Supporting Heroes (EMS, FIRE + POLICE)** -- you must have purchased a ticket with your registration. Lunch is served in the educational area of the event center. Your Badge indicates your lunch purchase on the back--this is your ticket.

1:00 PM - 1:50 PM

- ⓪ **HAND RAISING THE NEXT GENERATION EMS MENTORING** --VITO CICCARELLI AND KALEB HECK
- ★ **AIRWAY EMERGENCIES** --DR. JOSHUA PRUITT
- ★ **WHAT'S HAPPENING TO OUR MUSICAL HEROES? CHRONIC DISEASE OR POTENTIAL ACUTE CRITICAL ILLNESS--ASSESSMENT TO TREATMENT** --GARY WIEMOKLY
- ★ **NATIONAL EMS REFRESHER TRACK: PART 1 OF 2: WHAT'S THAT IN MY PATIENT? THE GOOD, THE BAD AND THE IMPLANTED** --REUBEN FARNSWORTH

2:00 PM - 3:15 PM

- ★ **TACTICAL HOSPITAL EMS COORDINATION FOR DISASTER (DISASTER FROM ONE SCENE TO ANOTHER)** --CHRISTOPHER WISTROM
- ★ **OPIOID EPIDEMIC: OVERDOSE SCENE MANAGEMENT** --LINDSAY SCHRADER
- ★ **A SHOUT AWAY : RESPONSE TO MASS CASUALTY INCIDENTS** --BILL JUSTICE
- ★ **NATIONAL EMS REFRESHER -PART 2 OF 2: WHAT'S THAT IN MY PATIENT? THE GOOD, THE BAD AND THE IMPLANTED** --REUBEN FARNSWORTH

3:15 PM - 3:45 PM

- **BREAK IN THE EXHIBIT HALL** --HYVEE HALL C
Give-Away Drawings Continue and Refreshments and a treat will be served in the exhibit hall for this break.

SPONSORED BY

Air Methods®
DEFENDERS OF TOMORROW™



SATURDAY NOVEMBER 9, 2019 SCHEDULE AT-A-GLANCE PLANNER

★ = FORMAL EMS CEH + NURSING Contact Hours

7:00 AM REGISTRATION OPENS

WATCH THE IEMSA.NET WEBSITE
for the full course descriptions on
the Registration Form.

7:30-8:15 AM — **HONORING OUR OWN CEREMONY** : Please join us in honoring those no longer with us at this moving ceremony. Upstairs in the Ballroom--Level 3. This ceremony starts promptly at 7:30am. Doors will be closed once the ceremony starts.

8:25 AM - 9:15 AM -- KEYNOTE SPEAKER GENERAL SESSION **BALLROOM**★ **BRINGING BATTLEFIELD MEDICINE TO OUR STREETS** --BILL JUSTICE

9:15 AM - 9:45 PM

- **BREAK IN THE EXHIBIT HALL--HYVEE HALL C**
Give-Away Drawings Continue and Refreshments and a treat will be served in the exhibit hall for this break.

- **YOUR CHANCE TO DROP OFF YOUR RAFFLE TICKET**
*DROP OFF YOUR RAFFLE ENTRY CARDS IN THE RAFFLE BAG AT THE IEMSA BOOTH#65 IN THE EXHIBIT HALL.

9:45 AM - 10:35 AM

- ★ **WHAT IS MOBILE INTEGRATED HEALTHCARE--COMMUNITY PARAMEDICINE IN IOWA?**
--MIKE VAN NIEWAAL, TERRY EVANS & LINDA FREDERIKSEN
- ★ **THE TOXIC HOUSE-WHAT CHILDREN FIND**
--GARY WIEMOKLY
- ★ **CAPNOGRAPHY: PREVENTING THE IN AND OUT BLUES**
--MIKE GRILL
- ★ **NATIONAL EMS REFRESHER TRACK: BEDROOMS, BATHTUBS AND BROOMSTICKS (PSYCHIATRIC/ BEHAVIORAL)** --REUBEN FARNSWORTH

10:45 AM - 12:00 PM

- ★ **AN OVERVIEW OF MIH-CP SERVICE DELIVERY MODELS IN IOWA WITH PANEL DISCUSSION**
--MIKE VAN NIEWAAL, TERRY EVANS & LINDA FREDERIKSEN
- ★ **PHTLS UPDATE**--MICHAEL KADUCE
- ★ **TBD**
--JEFF MESSEROLE
- ★ **NATIONAL EMS REFRESHER TRACK: VENTILATORY THEORY AND OXYGENATION** --REUBEN FARNSWORTH

3:25 PM - 4:40 PM — KEYNOTE SPEAKER--GENERAL SESSION - BALLROOM

★ **I'VE FALLEN 100 FEET AND CAN'T GET UP**— The logistics and care required to remove a victim and maintain a critical trauma patient in an austere environment will be discussed --BRUCE EVANS, AND VITO CICCARELLI

NOTE: The IEMSA Conference committee reserves the right to cancel or change any session or special event that does not meet minimum requirements, or to change a speaker as necessary. Formal designations are subject to change--final designations will be in the on-site printed Schedule-at-a-Glance.

NOON - 1:00 PM (EXHIBIT HALL CLOSING AT 1PM)

IEMSA AWARDS CEREMONY LUNCH --you must have purchased a ticket with your registration. Lunch is served in the educational area of the event center. Your Badge indicates your lunch purchase on the back--this is your ticket. **ATTENDEES Line-up on the far ends of the lunch hall. The center line is reserved for honorees and their guest.**

- **Lunch is also available at the FOOD VENDORS (BBQ, Mexican, Concession) IN THE EXHIBIT HALL**

1:00 PM - 2:15 PM

- ★ **PEDIATRIC AIRWAY EMERGENCY CASE STUDY**
--DAN MILLER
- ★ **CASE STUDIES IN PRE HOSPITAL CARE** --MIKE GRILL
- ★ **CONCUSSION INJURIES: HOW MANY FINGERS AM I HOLDING UP?**--GARY WIEMOKLY
- ★ **NATIONAL EMS REFRESHER TRACK: WHEN AND WHAT TO REPORT (AT-RISK POPULATIONS)**
--REUBEN FARNSWORTH

2:25 PM - 3:15 PM

- ★ **ISLAND EMS, NOT ALWAYS SUNSHINE AND PINA COLADAS NATURAL DISASTER DEPLOYMENT ON THE ISLAND OF ST. CROIX, USVI POST HURRICANE IRMA AND MARIA IN 2017**--ANDY NEY
- ★ **EMS AT THE MOVIES: MAKING YOUR EMS PROGRAM AND PROVIDERS STRONGER**--MARTIN HERKER
- ★ **PUBLIC ACCESS ON NALOXONE**
--MICHAEL KADUCE
- ★ **NATIONAL EMS REFRESHER TRACK: HOW ARE WE DYING? THE LATEST RESEARCH REGARDING EMS DRIVING AND INJURY (EMS RESEARCH)**
--REUBEN FARNSWORTH

IEMSA AFFILIATE MEMBERS -- A FREE SEAT IS WAITING FOR YOU at the **Pre-Conference Leadership/Management Workshop Track** -- IEMSA Annual Conference on November 7th-- just register for one AM and one PM workshop designated Leadership/Management Track and use code "AFF-Leader19" code at check-out when you register.



TOLL FREE 888-448-8881
www.arvambulance.com



Come visit us at booth V2

eso

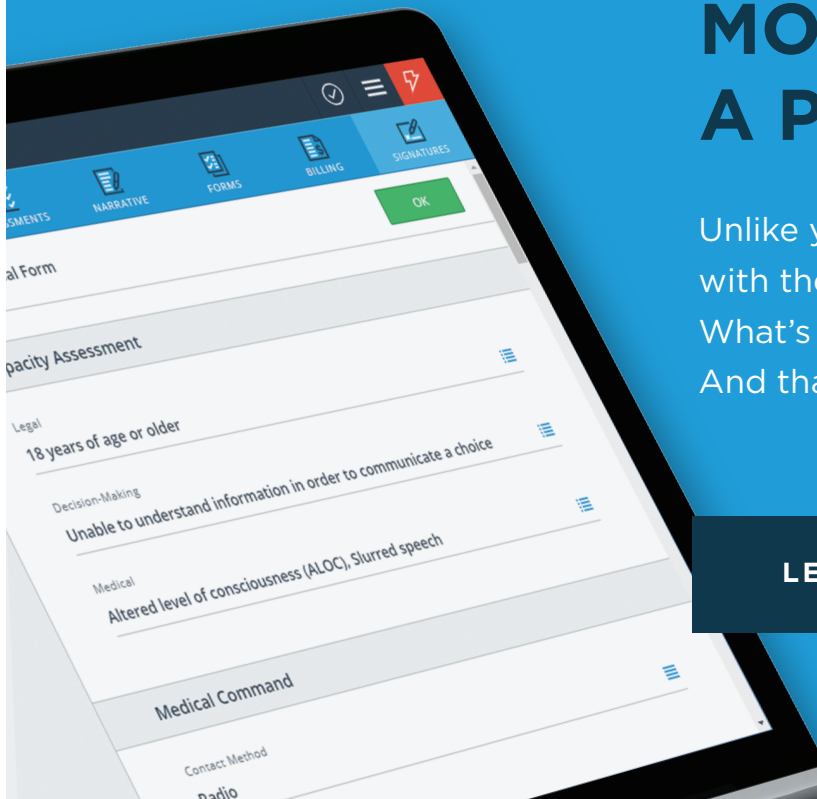

MORE THAN JUST A PRETTY FACE.

Unlike your old ePCR, ESO EHR arms you with the most useful tool of all: data. What's more, it's NEMSIS 3 compliant. And that's a beautiful thing.

LEARN MORE AT ESO.COM/EHR



2019 : 30TH ANNUAL IEMSA CONFERENCE REGISTRATION

REGISTER BEFORE **OCTOBER 31ST** TO AVOID A **\$50 LATE REGISTRATION FEE!**

FIRST NAME

LAST NAME

ADDRESS

CITY/STATE/ZIP

LAST 4-DIGITS OF SS#

DATE OF BIRTH (for CE Purposes):

PHONE

EMAIL

CERTIFICATION LEVEL

CERT/LICENSE #

IEMSA INDIVIDUAL MEMBERSHIP: SAVE UP TO \$90

[SIGN-UP OR RENEW NOW & PAY MEMBER PRICES TODAY!]

\$ _____ ☐ **NEW \$30/YR** ☐ **RENEW: \$30/YR**

THURSDAY : PRE-CONFERENCE WORKSHOP REGISTRATION

\$ _____ **FULL DAY CRITICAL CARE PARAMEDIC (CCP) REFRESHER**
\$120 MEMBER / \$150 NON-MEMBER

\$ _____ **FULL DAY DISASTER MANAGEMENT EMERGENCY PREPAREDNESS**
(limited to 40 students)
\$120 MEMBER / \$150 NON-MEMBER

\$ _____ **FULL DAY ACLS EXPERIENCED PROVIDER - CCP DIDACTIC AND HANDS-ON CLASS** (limited to 24 students)
\$120 MEMBER / \$150 NON-MEMBER

\$ _____ **FULL DAY NAEMT SAFETY COURSE** (must have 15 minimum students)
\$120 MEMBER / \$150 NON-MEMBER

*** IEMSA AFFILIATE MEMBERS: 1-PERSON --May attend the Leadership/Management Pre-Conference AM and PM sessions at no charge--Membership status will be verified. indicate "FREE" OR ONLINE APPLY PROMO CODE: AFF-Leader19**

\$ _____ **1/2 DAY: AM * SERVICE DIRECTOR/MEDICAL DIRECTOR WORKSHOP**
LEADERSHIP/MANAGEMENT PRE-CONFERENCE
\$60 MEMBER* / \$90 NON-MEMBER

\$ _____ **1/2 DAY: PM * "WHERE'S WALDO?" MISSING MANAGERS. MISSING EMPLOYEES. MISSING LEADERS.**
LEADERSHIP/MANAGEMENT PRE-CONFERENCE
\$60 MEMBER* / \$90 NON-MEMBER

\$ _____ **1/2 DAY: PM * CLINICAL GUIDELINES AND SCOPE OF PRACTICE**
LEADERSHIP/MANAGEMENT PRE-CONFERENCE
\$60 MEMBER* / \$90 NON-MEMBER

2-DAY : FRIDAY & SATURDAY CONFERENCE REGISTRATION

\$ _____ **\$220 MEMBER / \$290 NON-MEMBER**

\$ _____ **2-DAY LUNCH - PASS : \$30**

1-DAY : FRIDAY REGISTRATION

\$ _____ **\$165 MEMBER / \$240 NON-MEMBER**

\$ _____ **1-DAY LUNCH - PASS : \$15**

1-DAY : SATURDAY REGISTRATION

\$ _____ **\$165 MEMBER / \$240 NON-MEMBER**

\$ _____ **1-DAY LUNCH - PASS : \$15**

LATE FEES:

\$ _____ **+ \$50 LATE REGISTRATION FEE**
REGISTRATIONS REC'D AFTER 12 AM/OCTOBER 31ST

\$ _____ **TOTAL REGISTRATION FEES**



**REGISTER BEFORE
OCTOBER 31ST
& AVOID A
\$50 LATE FEE**

**ALL
REGISTRANTS
WILL
RECEIVE
AN IEMSA
GIFT ITEM!**

3-WAYS TO REGISTER:

> ONLINE BY CREDIT CARD: Go to **www.iemsa.net/conference**—click on "Register Now", complete the online form, make payment securely by credit card.

> COMPLETE THIS REGISTRATION FORM & MAIL WITH PAYMENT to confirm your registration. Make checks payable to IEMSA and mail to: 5550 Wild Rose Lane, Ste. 400, West Des Moines, IA 50266.

> COMPLETE THIS FORM AND FAX This method is **only for credit card payment registrations**. Fax to 877-478-0926.

REFUND POLICY: Refunds, less a \$50 processing fee, will be made for cancellations made prior to October 15th. No refunds made after Oct 31st.

REGISTRATION DEADLINE: Register prior to October 31st to ensure entrance to the conference. Registrations received after this date & on-site registrations may be limited. IEMSA will not invoice services for payment. PO's not accepted form of payment.

SPEAKER/SPECIAL EVENT CANCELLATION POLICY:

The IEMSA Conference committee reserves the right to cancel any session or special event that does not meet minimum requirements, or to change a speaker as necessary. Formal designations are subject to change--final designations will be in the on-site printed Schedule-at-a-Glance.



**CHOOSE YOUR BREAK-OUT SESSIONS
ON THE BACK OF THIS FORM.**

REGISTRATION FORM -----> CONTINUED ON PAGE 28



2019 : 30TH ANNUAL IEMSA CONFERENCE REGISTRATION

REGISTER BEFORE OCTOBER 31ST TO AVOID A **\$50 LATE REGISTRATION FEE!**

CONTINUED—

REGISTER BEFORE OCTOBER 31ST to AVOID a \$50 LATE FEE.

REGISTRANT'S FIRST NAME (REQUIRED FOR FAXING AND MAILING) :

REGISTRANT'S LAST NAME (REQUIRED FOR FAXING AND MAILING) :

3-WAYS TO REGISTER:

- > **ONLINE BY CREDIT CARD:** Go to **www.iemsa.net/conference**—click on "Register Now", complete the online form, make payment securely by credit card
- > **COMPLETE THIS REGISTRATION FORM & MAIL WITH PAYMENT** to confirm your registration. Make checks payable to IEMSA and mail to: 5550 Wild Rose Lane, Ste. 400, West Des Moines, IA 50266.
- > **COMPLETE THIS FORM AND FAX** This method is **only for credit card payment registrations**. Fax to : 877-478-0926.

REFUND POLICY: Refunds, less a \$50 processing fee, will be made for cancellations made prior to October 15th. No refunds made after Oct 31st.

REGISTRATION DEADLINE: Register prior to **October 31st** to ensure entrance to the conference. Registrations received after this date & on-site registrations may be limited. IEMSA will not invoice services for payment. PO's not accepted form of payment.

CANCELLATION POLICY: The IEMSA Conference committee reserves the right to cancel any session or special event that does not meet minimum requirements, or to change a speaker as necessary. Formal designations are subject to change--final designations will be in the on-site printed Schedule-

CREDIT CARD PAYMENT:

CREDIT CARD NUMBER

EXPIRATION DATE

SECURITY CODE

CARD HOLDER NAME

ADDRESS

CITY/STATE/ZIP

AUTHORIZED SIGNATURE

[THANK YOU]

*Refresher Certification Offered to qualified providers that attend all the National EMS Refreshers

> DAY 1 : FRIDAY, NOVEMBER 8TH, 2019

- 09:45 - 10:35
 - Neuro Emergencies
 - Surviving in the Cross Hairs : Response to Active Shooters
 - Pediatric Abuse: A Case Study
 - ***National EMS Refresher Track** : Hemorrhage Control + Fluid Resuscitation
- 10:45 - 11:55
 - 10 ways to ruin your ESO or your life
 - They're Just so Sweet! Children with Diabetes.
 - Too Much. Too Little. Too Long. (The Science of Cardiac Arrest Resuscitation)
 - ***National EMS Refresher Track** : Field Triage Review
- 1:00 - 1:50
 - Hand Raising the Next Generation EMS Mentoring
 - Airway Emergencies
 - What's Happening to Our Musical Heroes
 - ***National EMS Refresher Track**: PART 1 of 2--What's That in my Patient? Implanted Devices (Special Patient Populations)
- 2:00 - 3:15
 - Tactical Hospital EMS Coordination for Disaster from One Scene to Another
 - Opioid Epidemic: Overdose Scene Managements
 - A Shout Away : Response to Mass Casualty Incidents
 - ***National EMS Refresher Track**: PART 2 of 2 --What's That in my Patient? Implanted Devices (Special Patient Populations)

> DAY 2 : SATURDAY, NOVEMBER 9TH, 2019

- 09:45 - 10:35
 - What is Mobile Integrated Healthcare-Community Paramedicine in Iowa?
 - The Toxic House-What Children Find
 - Capnography: Preventing the In and Out Blues
 - **National EMS Refresher Track** : Bedrooms, Bathtubs, and Broomsticks (Psychiatric/Behavioral)
- 10:45 - 12:00
 - An Overview of MIH-CP Service Delivery Models in Iowa with Panel Discussion
 - PHTLS Update
 - Capnography: Preventing the In and Out Blues
 - **National EMS Refresher Track** : Ventilatory Theory and Oxygenation
- 1:00 - 2:15
 - Pediatric Airway Emergency Case Study
 - Case Studies in Pre Hospital Care
 - Concussion Injuries: How many fingers am I holding up?
 - ***National EMS Refresher Track** : When and What to Report (At-Risk Populations)
- 2:25 - 3:15
 - Island EMS, Not Always Sunshine and Pina Coladas
 - EMS at the Movies : Making your EMS Program and Providers Stronger
 - Public Access on Naloxone
 - **National EMS Refresher Track**: How are we dying? EMS Driving and Injury (EMS Research)

25 YEARS OF TRANSFORMING LIVES



1,378

Organ Donors



4,630

Organs Transplanted



10,551

Tissue Donors

Thousands of lives saved and hundreds of thousands of lives healed.

11,359 Donor Families Served

Save and Heal More Lives

Implement an agency protocol to call Iowa Donor Network for every death, every time. That one call could save and heal more lives than any other phone call you make.

Your duty doesn't stop when the pulse stops.



24 hour referral line
800-831-4131

FREE 1.0 CEH offered with
donation education

IowaDonorNetwork.org

